

# Punch Former

**51250**

PFD

ER Collet Punch Former

PUNCH FORMER



ER40

ER32

ER16

## Features :

- ▶ With ER collets, the flexible range of collet is 1mm.
- ▶ Clamping under 4mm apply ER16 collet.
- ▶ PFD can rapidly clamp the workpiece and achieving higher stability during processing, no need to adjust the center accuracy.
- ▶ PFD-SE16 come with high precision SE16 collet it has accuracy within 0.005mm and flexible range clamping is 0.5mm

PFD-SE16



N.W. 5.6kg



SE16

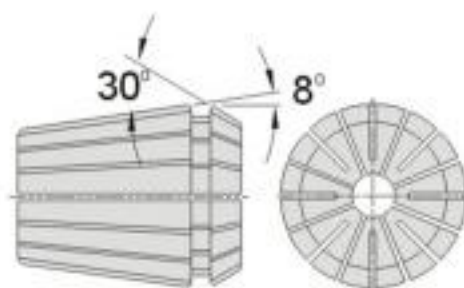

Collet Standard Accuracy

L	D	Accuracy
6	1.0-1.6	0.015
10	1.6-3.0	0.015
16	3.0-7.0	0.015
25	7.0-10.0	0.015
40	10.0-18.0	0.020
50	18.0-24.0	0.020
60	24.0-34.0	0.020

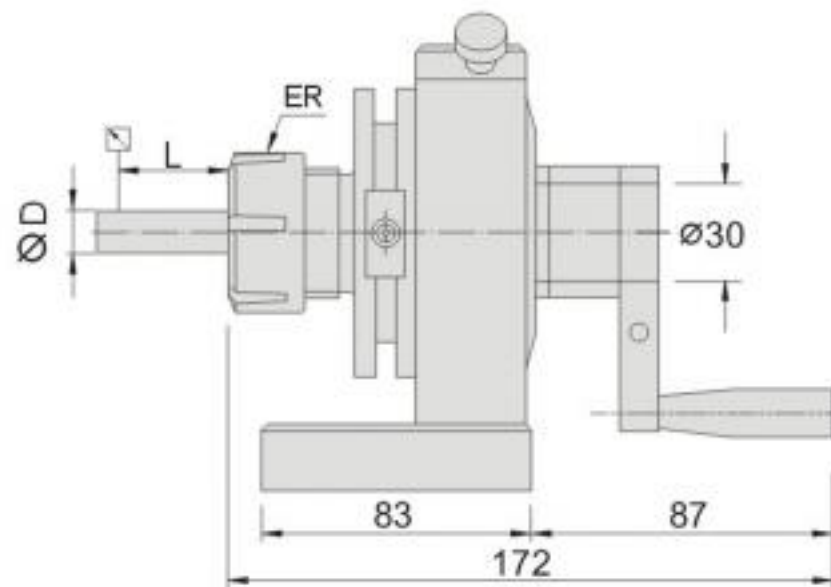
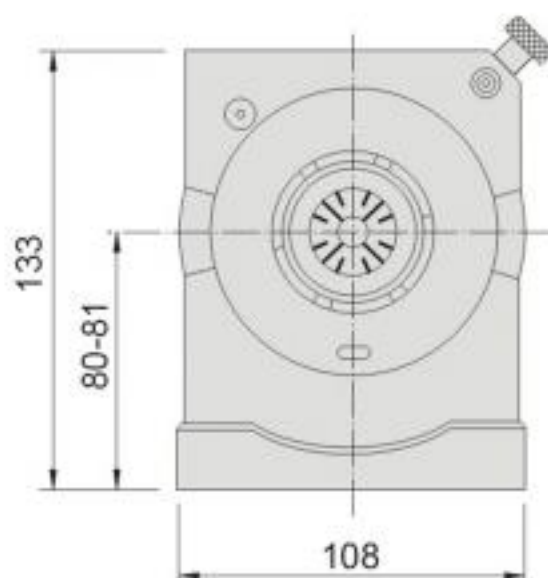

Order No.	Model	Collet Size	Collet Accuracy	N.W.
51250-16	PFD-ER16	2, 3, 4, 6, 8	0.010	5.6kg
51250-32	PFD-ER32	4, 8, 12, 16, 20	0.008	6.6kg
51250-40	PFD-ER40	6, 10, 16, 20, 25	0.008	7.6kg
51250-16A	PFD-SE16	2, 3, 4, 6, 8	0.005	5.6kg